

TABLE OF CONTENTS

1	INTRODUCTION
2	CONTACT DETAILS
2.1	Permanent contact details and key officials
2.2	Rally HQ Contact Details
2.3	Media Contact Details
3	PROGRAMME AND CRITICAL DEADLINES
3.1	Schedule before rally week
3.2	Schedule during rally week
4	ENTRY DETAILS
4.1	Titles for which the rally counts
4.2	Criteria for acceptance of entries
4.3	List of entry fees
4.4	Entry packages
5	SERVICE PARK
5.1	Information about the service park
5.2	Facilities at the service park
6	TYRES
	Single types and other information
7	RECONNAISSANCE
7.1	Registration
8	SHAKEDOWN
8.1	Schedule
9	MEDIA INFORMATION
9.1	Contact Details before the event
9.2	Contact Details at the event
9.3	Accreditation procedure, criteria and deadline
10	TWO-WAY RADIO
10.1	Application procedure
10.2	Contact details of person in charge
11	FUEL
11.1	General Conditions
12	HOSPITALITY ARRANGEMENTS
13	HELICOPTER USE
13.1	Registration procedure / details
13.2	Application form
13.3	National Helicopter companies
14	IMPORT OF VEHICLES AND SPARE PARTS
15	HOTEL ACCOMMODATION / RESERVATIONS
16	GENERAL FACTS

1. INTRODUCTION – WELCOME

Dear friends,

It is with great pleasure that I welcome you once again to the Cyprus Rally – round 3 of the 2009 FIA World Rally Championship.

It's great to be back in the WRC. And as you will see when our new and exciting event gets underway, we've been busy. Hosting two FIA Championship rounds in 2007 and in 2008 has certainly kept us on our toes and leaves us better prepared than ever to craft a truly exceptional WRC event for 2009.

Along with new routes, a new Service Park and more, we're also setting a precedent and launching a WRC first here in 2009. After careful consideration, the organisers of the Cyprus Rally, the Cyprus Automobile Association (CAA), have decided to take advantage of the WRC commission ruling that allows events to incorporate alternate surfaces. Therefore, Day 1 of the event will be an asphalt leg, while Days 2 and 3 will continue to offer the sort of challenging gravel stages for which our event is renowned.

The introduction of new challenges is always exciting in motorsport and fans and competitors alike are already trying to assess how this new approach will change the event. Certainly it is a new challenge for the crews and the organisers, but one that is sure to take this already exciting event from strength to strength. One major advantage of the new format is that it will also mean minimal double-use of gravel stages.

Organisers of other WRC events around the globe have already shown interest in adopting the mixed-surface approach for their events and some have already been in contact with the organisers to see how the CAA deals with the challenge.

As well as welcoming the top WRC teams, the 2009 Cyprus Rally will also be one of four events rewarding points for the Junior and Production WRC championships in 2009 and the news that a third of the event is to be run on asphalt will no doubt be welcome news to those crews, especially to drivers tackling the Rally in 2-wheel-drive vehicles.

Once again our event will be based around the lively coastal resort of Limassol, on the island's south coast. The perfect place to combine rallying with a holiday in the sunshine, Limassol is a fun and friendly town with an abundance of restaurants, bars and cafes.

Located close to the seafront, the new Service Park will be spacious, easily accessible, and laid out in accordance with the FIA's preferred 'outer hub' format. The Rally HQ will be located close by at the Four Seasons Hotel.

We're very proud to be returning to the WRC and invite you to join us for the Ceremonial Start of the event which will be held in Limassol on Thursday 12th March. We look forward to welcoming you to the Cyprus Rally in 2009.

Christos C. Kyriakides
Clerk of the Course

Please note that this document has no regulatory power. It is for information only.

2. CONTACT DETAILS

2.1 Permanent Contact Details

CAA Office

Address: 12, Chr. Mylona Street, 2014 NICOSIA, CYPRUS

Tel.: +357 22 31 32 33

Fax: +357 22 31 34 82

E-mail: caa@cytanet.com.cy

Website: www.cyprusrally.org

Key Officials

Clerk of the Course: Christos Kyriakides

Deputy Clerk of the Course: Nayia Kontopoulou, Andros Karaolides

ASN Scrutineer: George Papadakis

Competitors' Relations Officer: TBA

Press Officer: Chris Christodoulou

ASN Safety Officer: Loucas Loucaides

2.2 Rally HQ during the Rally

The Rally HQ will be based at the Four Seasons Hotel in Limassol.

Address: FOUR SEASONS HOTEL
67/69 Amathus Avenue, 4532 Ayios Tychonas, Cyprus

E-mail: caa@cytanet.com.cy

Website: www.cyprusrally.com.cy

2.3 Media Contact Details

Cyprus Rally Press Office
c/o Action Global Communications Limited
6 Kontilaki Street,
1090 Lefkosia, Cyprus

or

PO Box 24676,
1302 Lefkosia, Cyprus

Mr. Chris Christodoulou – Press Officer

Ms. Koulla Charalambous – Accreditation Officer

Telephone: + 357 22818884

Cyprusrallypressoffice@actionprgroup.com

3. PROVISIONAL PROGRAMME

3.1 SCHEDULE BEFORE THE RALLY WEEK

Wednesday 13 January	-	Opening date for entries
	-	Issuing of the supplementary regulations
Friday 6 February	-	Closing date for entries
Thursday 13 February	-	Date of issuing the Road Book
Friday 20 February	-	List of entries in seeded order published
	-	Closing date of placing FIA fuel order

3.2 SCHEDULE DURING THE RALLY WEEK

Monday 9 March		
16:00	-	Rally HQ and rally office opens
16:00 – 20:00.	-	Administrative checks and Collection of materials and documents
	-	Reconnaissance registration
Tuesday 10 March		
07:00	-	Reconnaissance
14:00	-	Media Accreditation open
Wednesday 11 March		
T.B.N.	-	Reconnaissance
T.B.N.,	-	Scrutineering/Marking & Sealing Priority 1 cars
16:00	-	Team Managers' Briefing
18:00	-	Doctors' Briefing (manufacturers)
Thursday 12 March		
08:00-10:00	-	Shakedown (P1, P2)
10:00-12:00	-	Shakedown (P1, P2, P3)
12:30-14:00	-	Shakedown (pre registered non priority drivers)
13:30	-	FIA Pre-Rally Press Conference
15:00	-	First Stewards Meeting
20:00	-	Ceremonial start of the rally
Friday 13 March		
	-	Start of Leg 1
	-	Finish of Leg 1
	-	Publication of Start List for Leg 2
Saturday 14 March		
	-	Start of Leg 2
	-	Finish of Leg 2
	-	Publication of Start List for Leg 3
Sunday 15 March		
	-	Start of Leg 3
	-	Finish of Rally / Prize Giving
	-	Final scrutineering
	-	Post-rally FIA Press Conference
	-	Publication of the Provisional Final Classification

4. ENTRY DETAILS

4.1. TITLES FOR WHICH THE RALLY COUNTS

- FIA World Rally Championship for Drivers
- FIA World Rally Championship for Manufacturers
- FIA Production Car World Rally Championship (for Drivers)
- FIA Junior World Rally Championship (for Drivers)

4.2. CRITERIA FOR ACCEPTANCE OF ENTRIES

Entries close on Friday February 6.

4.3. ENTRY FEES

4.3.1. Entry fees for Manufacturers 1 and 2 registered in the World Rally Championship will be as per the FIA World Rally Championship regulations. The entry fees are payable directly to the organizer as instructed in the FIA World Rally Championship regulations for 2009.

4.3.2. Other legal entities as defined by the organizers including FIA Production Car World Rally Championship entries.

4.3.3. Other entries as defined by the organizer (private entries)

4.3.4. Fees for Legal and Private Entries

Carrying optional advertising (per car)

Legal Entries	€5100.-
Private Entries	€3500.-

Not carrying optional advertising (per car)

Legal Entries	€7000.-
Private Entries	€4500.-

All above are subject to VAT (currently 15%)

- Private entrant
(other entries): Car entered by a member of the crew who competes under his/her own name.
- Legal entrant: Car entered by a team (not a Manufacturer 1 or 2), or a company which holds a legal entrant's license.
- Private or Legal entrants **not** carrying the organizer's optional advertising must notify it on their entry form.
- The entry fees, must be paid by bank transfer to the organizer's bank account:

Name of Bank:	Bank of Cyprus, Evrou Branch, Nicosia
Account Name:	CAA – Cyprus Rally
Account Number:	0108-01-004976-00
Swift Code:	BCYPCY2N
IBAN Account no.:	CY83 0020 0108 0000 0001 0049 7600
- All expenses are payable by the Competitor. Payment must be made in Euro.

4.4. The entry fees include:

	Manufacturer (2 cars)	Manufacturer (3 Cars)	Manufacturer Team (2 cars)	Manufacturer Team (1 car)	JRC/PWRC
Vehicle Plates					
• VIP (or guest) plates	10	12	8	4	1
• Service plates	6	9	4	2	1
• Auxiliary plates	12	15	8	4	2
Administration					
• Regulations (if printed)	10 (10)	12 (12)	8 (8)	4(4)	2 (2)
• Road book sets	12 (8)	15 (10)	8 (6)	4(4)	3 (2)
• Rally Guide 2	20 (15)	25 (20)	15 (10)	6(4)	3 (2)
• Route maps	20 (15)	25 (20)	15 (10)	6(4)	5 (2)
• Programme	20	20	15	6	5
• Results books	5 (5)	6 (6)	5 (5)	3(3)	2 (2)
• CD of safety plan	1	1	1	1	0
Passes					
• Team guest passes	40	50	30	10	0
• Team passes(if required) can be wristbands	30	40	25	15	0

5. SERVICE PARK

5.1. INFORMATION ABOUT THE SERVICE PARK

- 5.1.1. The Service Park will be located on the seafront in Limassol close to the headquarters.
- 5.1.2. During the rally servicing is allowed only in the service park, as defined in the FIA General Prescriptions for Rallies. This service park is marked in the road book and the maps of the rally. Manufacturers entered in the FIA World Rally Championship will have a designated area in the service park according to the recommendations of the FIA. The teams may bring their auxiliary vehicles into the service park, as long as they can park within their designated area. Otherwise these vehicles will have to be taken to the auxiliary parking adjacent to the service park.
- 5.1.3. Service and auxiliary plates will be distributed during the material collection.
- 5.1.4. The organizers have made provision for the setting up of the paddock from the 8.03.2009 for the manufacturers and the foreign teams.

5.2. FACILITIES AT THE SERVICE PARK

- 5.2.1. Facilities available to all competitors / tyre manufacturers:
- General security
 - General lighting
 - Public toilets
 - Water: competitors should provide their own pipes to access this service.
 - Waste collection
 - Waste oil tank
- 5.2.2. **Additional facilities available (to be charged extra)**
Competitors wishing to order any of the following facilities must contact the organizers:
- Toilet hiring & servicing
 - Hiring of portable waste collection tank
- 5.2.3. **Private security** will be available. Competitors wishing this service must contact the organizers directly.

WRC Cyprus Rally 2009
Germasogia Service Park

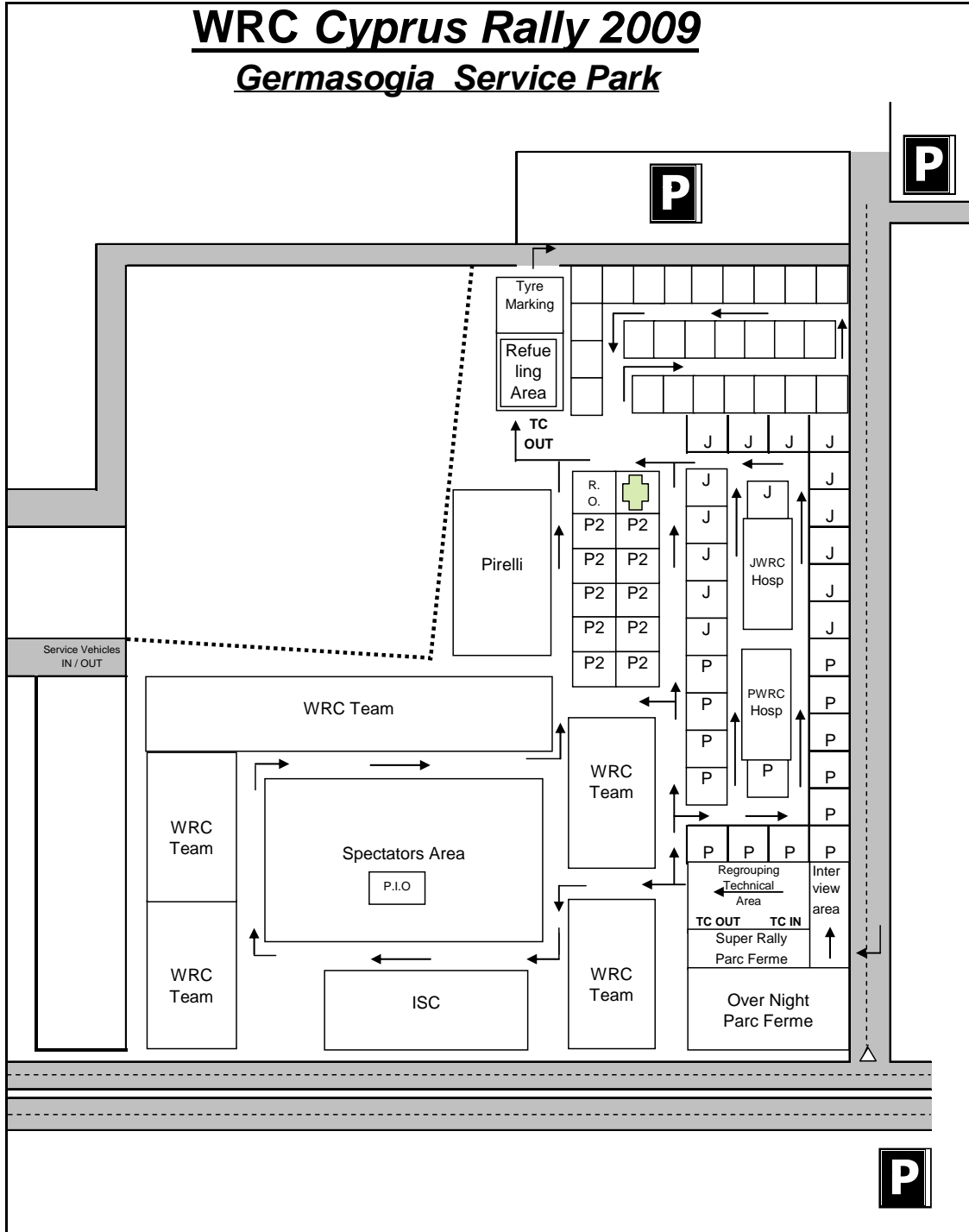

6. TYRES

Pirelli has been nominated by the FIA as the single tyre supplier to distribute the tyres for the rallies in the Championship. All drivers entering a 4WD must use the tyres specified by the FIA. Should competitors have any inquiries concerning the tyres, please contact Pirelli at following details:

Pirelli Pneumatici S.p.A.,
Attention: Mr. Paul Hembery
Motorsport Director
Viale Sarca, 222
I-20126 Milano, Italy

Tel: +39 02 6442 7916
Fax: +39 02 6442 9291
e-mail: paul.hembery@pirelly.com

7. RECONNAISSANCE

7.1. REGISTRATION FOR RECONNAISSANCE

Reconnaissance will take place as per the programme. The reconnaissance material will be available for competitors at the administrative checks. This material will be given to the drivers personally or to representative duly authorised in writing at the Rally Secretariat.

8. SHAKEDOWN

8.1. SCHEDULE

The shakedown will take place on Thursday 12 March 2009.

08:00 – 10:00 hours	P1, P2 drivers
10:00 – 12:00 hours	P1, P2, P3 drivers
12:30 – 14:00 hours	pre registered non priority drivers

9. MEDIA

9.1. Contact Details before the event

Cyprus Rally Press Office
c/o Action Global Communications Limited
6 Kontilaki Street,
1090 Lefkosia, Cyprus

or
PO Box 24676,
1302 Lefkosia, Cyprus

Mr. Chris Christodoulou – Press Officer
Ms. Koulla Charalambous – Accreditation Officer
Telephone: + 357 22818884

9.2. Contact Details at the event

All media enquiries should be directed to the following:

Chris Christodoulou – Press Officer
Koulla Charalambous -Accreditation Officer

Press Office, Cyprus Rally,
c/o Action Global Communications Ltd
6, Kontilaki Street,
1090 Lefkosia, Cyprus.
PO Box 24676, 1302 Lefkosia, Cyprus

Telephone Number: + 357 22818884
Telefax Number : + 357 22873632
E-mail : Pressoffice@actionprgroup.com
Website : www.cyprusrally.org

9.3. Accreditation Procedure, criteria and deadlines

NATIONAL PRESS/SMALL NATIONAL AGENCIES

An accreditation form will be posted on the event's website (www.cyprusrally.org.cy) on or before the 9th January for national photographers/journalists and small news agencies. The form should be completed and signed by the Editor-in-Chief and forwarded to the Accreditation Officer: Koulla Charalambous at the Media Contact address.

Deadline for National Press: All accreditation requests must be received by the Accreditation Officer no later than **13th February 2009**.

INTERNATIONAL MEDIA

All international media and International Agencies must complete an Accreditation form obtained from the FIA website www.fia.com or supplied by the FIA External Relations Department: Tel: +33 1 43 125 812 or Fax +33143125818

Deadline for international media

All accreditation requests must be received by the FIA no later than **20th February 2009**

ALL TV, RADIO, WEBSITES, ELECTRONIC MEDIA AND COMMERCIAL PHOTOGRAPHERS

Requests for accreditation from any of the above should be sent to:

International Sportsworld Communicators
Accreditation Service
The Annex
Maynard House
46-52 Pentonville Road
LONDON N1 9HF
Tel: 44 207 584 7584
Fax: 44 207 278 3753
Email: accreditations@iscrally.com

Each application to include:

1. A formal request for accreditation, written on the publication's official letterhead, signed by a Director of the publication or the Editor. Requests signed by clerical staff will not be accepted
2. A completed Accreditation Form
3. Written confirmation of the publication's frequency and circulation figures
4. An original copy of the publication
5. Examples of published material from previous WRC Cyprus Rallies
6. A photocopy of the National Press Card(s) where applicable of the representatives who will be attending the Cyprus Rally
7. Requests from freelancers must be accompanied by copies of their published work during the last 12 months, specifying the names of the publications / newspapers in which the work has been published.

Items 3 and 4 do not apply to major international press agencies. Item 5 does not apply to publications applying for the first time.

Under no circumstances will Advertising, Pr and Marketing agencies, together with sponsor representatives' be eligible for accreditation

INFORMATION FOR ACCREDITATION APPLICATIONS

1. A maximum of three representatives per organization will be considered for accreditation. A separate application form should be submitted for each person to be accredited and all documentation included.
2. The application must be received by the due date stated.
3. The publication must have a circulation size and quality that satisfies the criteria of the FIA
4. The publication must be on sale to the general public via retail outlets, (trade or internal company magazines will normally not be accredited) However, at the sole discretion of the FIA and where the quality and circulation criteria justify their consideration, such magazines may be eligible for accreditation on a case by case basis.
5. Photographers must follow the same criteria. Publications or agencies applying for a single round must supply evidence of independent coverage of a minimum of 15 pictures per pass at each event they have been accredited for in the previous years Championship.
6. Photo agencies must be able to prove that pictures have been regularly sold to publications matching the FIA criteria.
7. The number of photographers' media passes issued for the national media will not exceed 12. Should there be more, a pool system is recommended.

Photographers not complying with the above (e.g., commercial photographers) must apply for accreditation to **ISC Accreditation Service**

When applications have been approved, a letter or email confirming the successful accreditation will be sent to the applicant(s), together with the Liability Waiver.

During accreditation at the Cyprus Rally, no passes will be handed out without the Letter of Confirmation and the Liability Waiver (which should be signed by the same person that signed the application form), being produced.

For further information on Accreditation: www.fia.com/mediacentre/Accrediation/WRC/2008/wrc

10. TWO WAY RADIO

10.1. APPLICATION PROCEDURE

Radio transmitters are subject to licensing. The Organizers have made the necessary applications and a number of frequencies are available for the competitors use. Please inform us the soonest of your existing radio frequencies in order to check if these are available for use.

Bear in mind that throughout the rally, the use of frequencies for amateur radio is prohibited. At the pre-event scrutineering, the radio transmitters and the licenses will be inspected. Radio transmitters in aircraft will be inspected too. The use of radio transmitters will be monitored throughout the rally. Unlicensed use or use outside the terms of a license of a radio transmitter may lead to prohibition of the use of the radio transmitter.

10.2. CONTACT DETAILS TO PERSON IN CHARGE

License for the use of radio transmitters must be applied for at the Rally Office either by fax at (+357) 22 313 482 or through e-mail at caa@cytanet.com.cy.

11. FUEL

11.1. FUEL/REFUELLING REGULATIONS

The use of FIA fuel is compulsory for **all priority drivers**.

FIA fuel, as provided by the FIA appointed supplier, must be used by all Priority drivers Non-priority drivers may use commercially available pump fuel dispenses from pumps at filling stations marked in the road-book.

No later than 3 weeks prior to the start of the rally, competitors must notify their fuel requirements to the sole supplier at the following address:

Shell Global Solutions – Germany
PAE – Labor
Attn. Mr Richard Karlstetter
Hohe Schaar Strasse 36
21107 Hamburg
Germany

Tel: +49 40 7565 4715
Fax: +49 40 7565 4502
Email: richard.karlstetter@shell.com

11.1.2. Cars of priority drivers must be fitted with FIA fuel sample couplings, although the FIA reserves the right to check the fuel of any competitor. All competitors are required to fit refuel couplings, except non priority drivers using a car which retains the standard tank.

11.1.3. The FIA reserves the right, at all times and without having to state the reasons, to replace the FIA fuel with another fuel conforming to the Sporting Code (Appendix J.)

12. HOSPITALITY ARRANGEMENTS

For details of the hospitality arrangements please contact our booking office as follows:

Mr Costas Kyriakides

Tel: +357 22 31 32 33

Fax: +357 22 31 34 82

E-mail: caa@cytanet.com.cy

13. HELICOPTER USE

13.1 REGISTRATION PROCEDURE/INFORMATION

In compliance with the FIA Safety Regulations and the local Air Traffic Authority, every helicopter flying in support of the rally must be registered with the organizers.

13.2 APPLICATION FORM FOR REGISTRATION

Please apply to the Rally Office in order to get the relevant form.

13.3 CONTACT DETAILS FOR NATIONAL HELICOPTER COMPANIES

For helicopter rental, please contact the Rally Office.

14. IMPORT OF VEHICLES AND CUSTOMS

The ATA carnet is not a requirement for bringing your equipment into Cyprus. If you already have one it is useful.

The Organizers arranged with the Chief of Customs for the following procedure:

1. A list of all equipment carried in each van or truck, signed and stamped by your company must be brought by the driver or other accompanying person. Copy of this list should be faxed to the organizers beforehand.
2. Photocopy of the passport of each driver of each vehicle, and photocopy of each vehicle's logbook should also be faxed.
3. In order for a car to be released from customs, a written and signed authorization by the vehicle owner, naming the driver authorized to import the car, must be presented. If the owner is a company the authorization should also bear the company's stamp.
4. Upon arrival, random checks shall be carried out by customs officers to ascertain that the items in the trucks are actually on the respective lists.
5. The same procedure shall be followed on departure so as to verify that all items imported are actually exported even if they are damaged.
6. We shall make arrangements for a clearing agent to be at the port in order to expedite procedures.

15. HOTEL ACCOMMODATION / RESERVATIONS

All accommodation arrangements will be taken care of by our booking office which will arrange these centrally.
For booking form and contact details contact

Yioula Kyriakides
Travelscope

Tel: +357 25 343 111
Fax: +357 25 345 834

E-mail:
yioula@travelscope.com.cy

We recommend that all competitors specify their needs as soon as possible so that the relevant bookings are made in time.

BOOKING FORM FOR ACCOMMODATION REQUIREMENTS

Name of the team or company	
Name of the driver or guest	
Name of the co-driver or guest	
Contact person	
Address	
Tel:	
Fax:	
Mobile:	
e-mail:	
Required accommodation:	
Arrival:	
Departure:	

16. GENERAL FACTS

Cyprus is the third largest island in the Mediterranean after Sicily and Sardinia. It covers an area of 9251 square kilometres and the main mountain range is the Troodos range with its highest peak, Mount Olympus, at 1921 metres. The population numbers just less than one million and the main language is Greek but English is very widely spoken.

There are four main towns: Nicosia (Lefkosia), the capital, Larnaca (Larnaka), Limassol (Lemesos) and Paphos (Pafos). The airports are at Larnaca and Paphos and modern motorways link all the main towns. The seaport is at Limassol.

APPROXIMATE DISTANCES BETWEEN TOWNS

Larnaca Airport to Limassol	70 kms
Larnaca Airport to Paphos	139 kms
Limassol to Nicosia	82 kms
Limassol to Paphos	68 kms
Limassol to Troodos	46 kms
Paphos to Troodos (via Limassol)	114 kms

CLIMATE

Cyprus has an intense Mediterranean climate, with long dry summers and mild winters. The March mean daytime temperature on the coast is 19.4°C with 10.0°C at night. The temperatures in the hills are 12.8°C and 4.4°C. The weather forecast can be found on the Internet at www.cyprus-weather.com

TIME ZONE

Cyprus time is GMT+2 in winter, which is from the last Sunday in October to the last Sunday in March. Summer time is GMT +3.

SUNRISE AND SUNSET

	Sunrise	Sunset
Friday, 13 March	06.00	17.52
Saturday, 14 March	05.59	17.53
Sunday, 15 March	05.57	17.54

CURRENCY AND BANKING

The currency is the Euro (€).

There are no restrictions on the import or export of either local or foreign currency.

Banks operate from Monday to Friday from 0830 to 1230. They do not open on Saturdays.

Banks in the main tourist areas provide an afternoon tourist service and most banks have ATMs, which accept the majority of major credit and bankcards. A number of automatic currency exchange machines operate on a 24-hour basis in major town centres and main tourist resorts.

Hotels, large shops, restaurants etc. usually accept travellers' cheques and major credit cards

ELECTRICITY

The electricity supply is 240 volts AC 50Hz. Sockets are 13amp, square pin. Adapters are available on request at most hotel reception desks and they can be purchased from supermarkets, grocery shops etc.

WATER

It is safe to drink tap water in Cyprus, as there are no water-borne diseases. However, due to the climate, Cyprus has severe water shortages and it is important not to waste water.

DRIVING IN CYPRUS

Visitors to Cyprus need a valid national or international driving licence, provided it is valid for the class of vehicle they wish to drive. To hire a car, the driver must be over 25 years of age and have held a valid national/international licence for at least three years.

FUEL

Petrol, diesel and unleaded petrol are freely available at EKO, Mobil, Esso, Lina, Petrolina and Agip stations. Petrol is sold by the litre. Petrol stations are open at the following times:

Monday to Friday:	0600 – 1900
Tuesday:	0600 – 1400 in the Limassol, Larnaca and Paphos Districts. Stations are open all day in the Nicosia District.
Wednesday:	0600 – 1400 in the Nicosia District only. Stations are open all day in the other districts.
Saturday:	0600 – 1500.

All petrol stations are closed on Sundays, but most stations have fuel vending machines, which accept bank notes and credit cards. Vending machines operate during non-working hours and the instructions are in English.

Mini guide for drivers

Traffic moves on the left hand-side of the road.

The maximum speed limit on the motorways is 100 km/h and the minimum is 65 km/h. On all other roads, the maximum speed limit is 80 km/h. In built-up areas the speed limit is 50km/h, unless otherwise indicated.

The use of **front and rear seat belts** is compulsory.

Crash helmets must be worn on all motorbikes and scooters.

It is illegal to use a **hand-held mobile phone** while driving. It is legal to use a hands-free unit.

Driving with an **alcohol level** above 22 milligrams per 100 millilitres of breath is an offence.

Rush hours in the towns are approximately between 0730 and 0800 and between 1300 and 1330 and in the late afternoon

FOOD AND WINE

Food-lovers will appreciate Cypriot cuisine, as it consists of many varied dishes and flavours. Some specialities are favourites with visitors to the island.

Meze – a collection of over 20 different appetisers and savoury dishes. This is a meal not to be hurried.

Kebab (or souvlaki in Greek) – small chunks of charcoal grilled pork or chicken, served in pitta bread with salad.

Souvla – large chunks of charcoal grilled lamb, served with salad and roast potatoes.

Stifado – beef or hare, cooked in wine, vinegar, onions and tomatoes.

There is a great variety of Cyprus wine: red, white and rose. Four brands of beer: KEO, Carlsberg, Leon and 5, are brewed on the island. Cyprus is famous for the Brandy Sour, which is made from Cyprus brandy, lemon juice, angostura bitters, soda water and ice.

LIMASSOL CAR RENTAL AGENCIES

ECONOMY CAR CYPRUS

4, Persefonos Street,
Limassol 33-100

Tel: +357 99814656
www.economycarcyprus.com

AVIS – LIMASSOL

2, Andrea Syngrou Street,
Limassol 4040

Tel: +357 25 324192
www.avis.com

DDS CAR RENTAL

35 King George Street
Limassol 4060

Tel: +357 25 327657
www.ddscarrentals.com

OASIS RENT A CAR

28TH October Street,
Shop D
Limassol

Tel: +357 25 745588
www.oasisrent.com.cy

STREETWISE RENTAL LTD

7 Idras Street,
Germasoyeias, Limassol 3315

Tel: +357 25 318703
www.streetwise.com.cy

ANDREAS PETSAS & SONS

Odos Georgiou A
Sea Breeze Court
, Shop 1
Germasogeia

Tel: +357 25 323672
carrentals@petsas.com.cy

EUROPE CAR

38 Omonia Avenue
Limassol

Tel: +357 25 880222
www.europcar.com

HERTZ – Limassol

61, Georgiou A Street,
Limassol 4047

Tel: +357 25 323758
www.hertz.com

NATIONAL CAR RENTAL

Old Nicosia Road
Limassol 1111

Tel: +357 323365
www.nationalcar.com

SIXT - Limassol

Georgiou 1ST Avenue
Limassol 4048

Tel: + 357 25 312345
www.sixtusa.com

ASTRA SELF DRIVE

Georgiou A, Seagate,
Shop 3-6

Tel: +357 77 77 78 00
reserve@astragroup.com

More car rental companies can be found on the website: www.CyprusNet.com

AIRLINES AND AIRPORTS

AGEAN AIRLINES

Tel: + 357 22 654000

**AEROFLOT INTERNATION RUSSIAN
AIRLINE**

31 Omirou Avenue
Lefkosia, 1097
Tel: + 357 22 669071

AIR LANKA

54-58 Evagorou Avenue,
Lefkosia 1096
Tel: + 357 22670764

ALITALIA AIRLINES

54-58 Evagora Avenue,
Lefkosia 1096
Tel: + 357 22 674500

AUSTRIAN AIRLINES

Tel: + 357 22 881188

CYPRUS AIRWAYS

Tel: + 357 80000008

CZECH AIRLINES

36E Griva Digeni Avenue
Lefkosia 1066
Tel: + 357 22 667767

BRITISH AIRWAYS

15, Esperidon Street
Strovolos 2001
Tel: + 357 22 799999

EGYPT AIR

Tel: + 357 22 559200

EMIRATE AIRLINES

66E Arch. Makariou III Avenue,
Kronos Court
Lefkosia 1077
Tel: + 357 22 817816

EUROCYPRIA AIRLINES

Tel: + 357 80000809

JAT AIRWAYS

82, Arch. Makariou III Avenue
Lefkosia 1077
Tel: + 357 22 753500

K.L.M ROUAL DUTCH AIRLINES

12, Zinas Kanther
Lefkosia 1065
Tel: + 357 22 671616

LIBYAN ARAB AIRLINES

12-14 Panteli Katelari

Lefkosia 1097
Tel: + 357 22 668747

LUFTHANSA GERMAN AIRLINES

3, Nikis Avenue
Xenos Tower
Lefkosia 1086
Tel: + 357 22 873330

MALEV HUNGARIAN AIRLINES

5, Deligeorgi
Shop 2,
Lefkosia 1066
Tel: + 357 22 680980

MIDDLE EAST AIRLINES

17 Evagorou Avenue
Lefkosia 1065
Tel: + 357 22 673132

OLYMPIC AIRWAYS

Tel: + 357 22 716300

ROYAL JORDANIAN AIRLINES

66A Arch. Makariou III Avenue
Lefkosia 1077
Tel: + 357 22 460044

TAROM ROMANIAN AIR TRANSPORT

2 Naxou
Lefkosia 1070
Tel: + 357 22 375266

We have given the telephone numbers and address for Lefkosia only, as the majority do not have offices in other towns.

More information can be found on: www.CyprusNet.com or www.cyprus-yellowpages.com

AIRPORTS

There are two main airports in Cyprus, Larnaka and Pafos, operated by Hermes Airports Limited.

To contact them:
Hermes Airport Ltd
Head Office,
PO Box 43027
6650 Larnaka International Airport
Larnaka, Cyprus

Tel: + 357 24 816400
Email: info@hermesairports.com

Customer Service Desk
Covering Larnaka and Pafos International Airports (24 hours)

Tel: + 357 24 816426
Email: customerservices@hermesairports.com

COPY SERVICE

Alpha Graphics

22B Karaiskaki
Lemesos 3032

Tel: + 357 25 365345

ENOS PHOTOCOPYING

45 Agias Fylaxeos
Drousotis Building
Shop 05
Lemesos 3025

Tel: + 357 25 762500

MAIL BOX

Agias Zonis
Nicolau Pentadromos Centre
Shop 25
Lemesos 3027

Tel: + 357 25 35285

USEFUL TELEPHONE NUMBERS

Police/Fire/Ambulance	112
Police Headquarters Nicosia	22802020
Forest Department	1407
Air Sea Rescue	1441
Major Hospitals (enquiries)	1400
Private Doctors on call (Weekends, Public Holidays	
Nicosia	90901422
Larnaca	90901424
Limassol	90901425
Paphos	90901426
Late night pharmacies	
Nicosia	90901402
Larnaca	90901404
Limassol	90901405
Paphos	90901406
Airports	
Larnaca	77778833
Paphos	26801810
Cyprus Telecommunications Authority	
Operator & Customer hotline	132
National Directory Enquiries	11892
International Directory Enquiries	11894
International calls via operator	80000198

